

### Contact details

For more information, please contact the Training Centre Manager.

Telephone: +61 2 6202 3522  
Facsimile: +61 2 6202 3799  
Email: [nationalcalendarteam@apsc.gov.au](mailto:nationalcalendarteam@apsc.gov.au)  
Level 5, 16 Furzer Street, Woden ACT 2606, Australia



**Australian Government**  
**Australian Public Service Commission**



**Australian Government**  
**Australian Public Service Commission**

**Australian Public Service Commission**

# Training Centre



**Learn. Lead. Succeed.**



## Overview

Whether planning for a large or a small group, the Australian Public Service Commission Training Centre team can assist you with quick and convenient service.

The Training Centre's meeting and conference facilities consist of five rooms, three of which have natural light, and offer 408 square metres of first-class meeting facilities, which can be easily configured to accommodate a variety of different sized meetings or events. The Training Centre is wheelchair friendly and within a secure building. For board meetings, conferences, lunches and cocktail parties, the Training Centre's versatile function rooms welcome groups of five to 180.

Each meeting or event is considered a priority and the Australian Public Service Commission aims to provide a full event service that includes state-of-the-art audio visual equipment and a full complement of meeting aids and technical assistance. Our dedicated staff provide outstanding service to both small and large groups and are happy to assist with arranging even the smallest request quickly and efficiently.

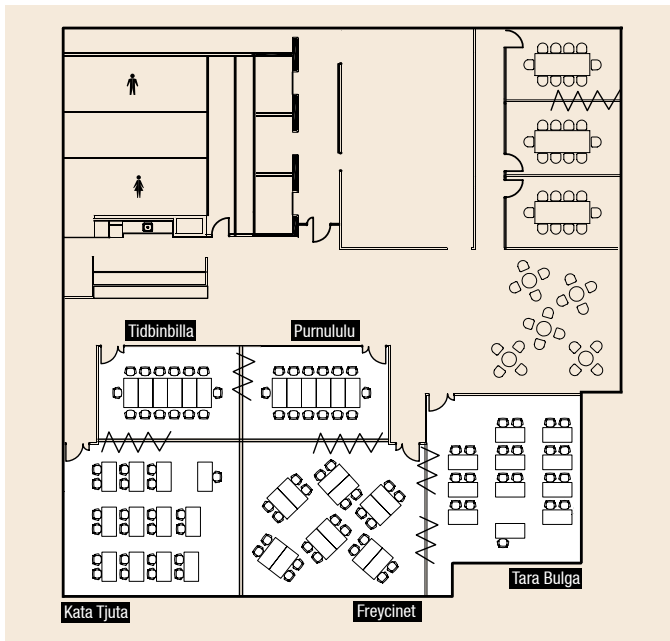

## Function space capabilities

Capacity figures indicated in the table below are based on maximum numbers and may vary depending on your specific technical requirements.

With some of the most fantastic views in Canberra, the Training Centre is the perfect venue for your next conference or event. Our team, full of creative ideas, can organise a variety of optional extras to enhance your event and make it one to remember.



Venue	Kata Tjuta	Tara Bulga	Freycinet	Purnululu	Tidbinbilla	Whole venue
Theatre style	45	40	40	25	25	175
Classroom	30	30	30	15	15	120
U-Shape	30	25	25	-	-	80
Boardroom	20	20	20	14	14	88
Cocktail	50	50	40	20	20	180